

| 1 |

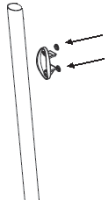

Attach plastic curtain rail pole clip to pole using provided self tapper screws and cap covers.

| 5 |

Slide the bottom of the pole firmly onto the fixed panel mount, ensure that the pole is seated completely. Clip the curtain rail pole clip onto the curtain rail. Hold the pole firmly down to stop it from lifting off the fixed panel mount and slide the plastic ceiling mount to be flush with the ceiling.

| 2 |

It is necessary to measure from the top of the installed half height fixed panel to the ceiling. The top end of the pole must be cut (This is the shorter section above the curtain clip). Using a suitable tool cut the pole 10mm less than the taken measurement.

| 6 |

Check the plumb with a builders level and attach the plastic ceiling pole mount to the ceiling using suitable screws and provided cap covers. To ensure a proper ceiling mount it may be necessary to add a bridge between the ceiling joists above the plasterboard and screw the ceiling pole mount into it.

| 3 |

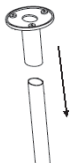

Attach the plastic ceiling pole mount to the pole by sliding it down onto the top of the pole, the flanged end must be uppermost. Slide the mount onto the pole until it is level with the top of the pole.

| 7 |

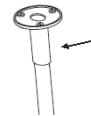

After the pole is in place and fully seated, drill a hole using a 3.50mm drill, through one side of the ceiling mount into the pole. Fit self tapper screw and cap cover provided.

| 4 |

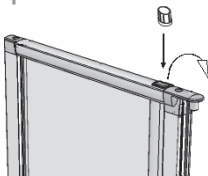

Remove the plastic Easa badge holder from the top of the fixed panel. Unscrew the 2 screws that are revealed below it. Replace the badge holder with the plastic pole mount and screw it into place with the existing screws.

